

**TOWN AND COUNTRY PLANNING
(GENERAL PERMITTED DEVELOPMENT) ORDER 2015
DIRECTION MADE UNDER ARTICLE 4(1)**

**(SIDMOUTH AVENUE, GOWER STREET, GRANVILLE
AVENUE, NORTHCOTE PLACE AND KING STREET)**

WHEREAS the Borough Council of Newcastle-under-Lyme Borough I being the appropriate local planning authority is satisfied that it is expedient that development within its area of the description set out in the Schedule below should not be carried out on the land shown edged red on the attached plan unless planning permission is granted on an application made under part III of the Town and Country Planning Act 1990 as amended.

NOW THEREFORE the said Council in pursuance of the power conferred upon them by article 4(1) of the Town and Country Planning (General Permitted Development) Order 2015 hereby direct that the permission granted by article 3 of the said Order shall not apply to development on the said land of the description set out in the Schedule below:

SCHEDULE

Development consisting of a change the use of a building to a use falling within Class C4 (houses in multiple occupation) of the Schedule to the Town and Country Planning (Use Classes) Order 1987 from a use falling within Class C3 (dwellinghouses) of that Schedule, being development comprised within Class L of Part 3 of Schedule 2 to the said Order and not being development comprised within any other Class.

The Article 4 direction is made on the 17th December and shall come into force on 22nd December 2015

THE COMMON SEAL of THE)
BOROUGH COUNCIL OF)
NEWCASTLE-UNDER-LYME)
was hereunto fixed in the)
presence of:)



Mayor/Councillor



Authorised Signatory



Confirmed under the Common Seal of The Borough Council of
Newcastle-under-Lyme this day of June 2016.

The COMMON SEAL of THE)
BOROUGH COUNCIL OF)
NEWCASTLE-UNDER-LYME)
was hereunto affixed in the)
presence of:)



Mayor/Councillor



Authorised Signatory



**Article 4 Direction Boundary –
Sidmouth Avenue, Gower Street,
Granville Avenue Northcote Place
and King Street**

1:2,000 at A4

 Proposed Article 4 Direction boundary

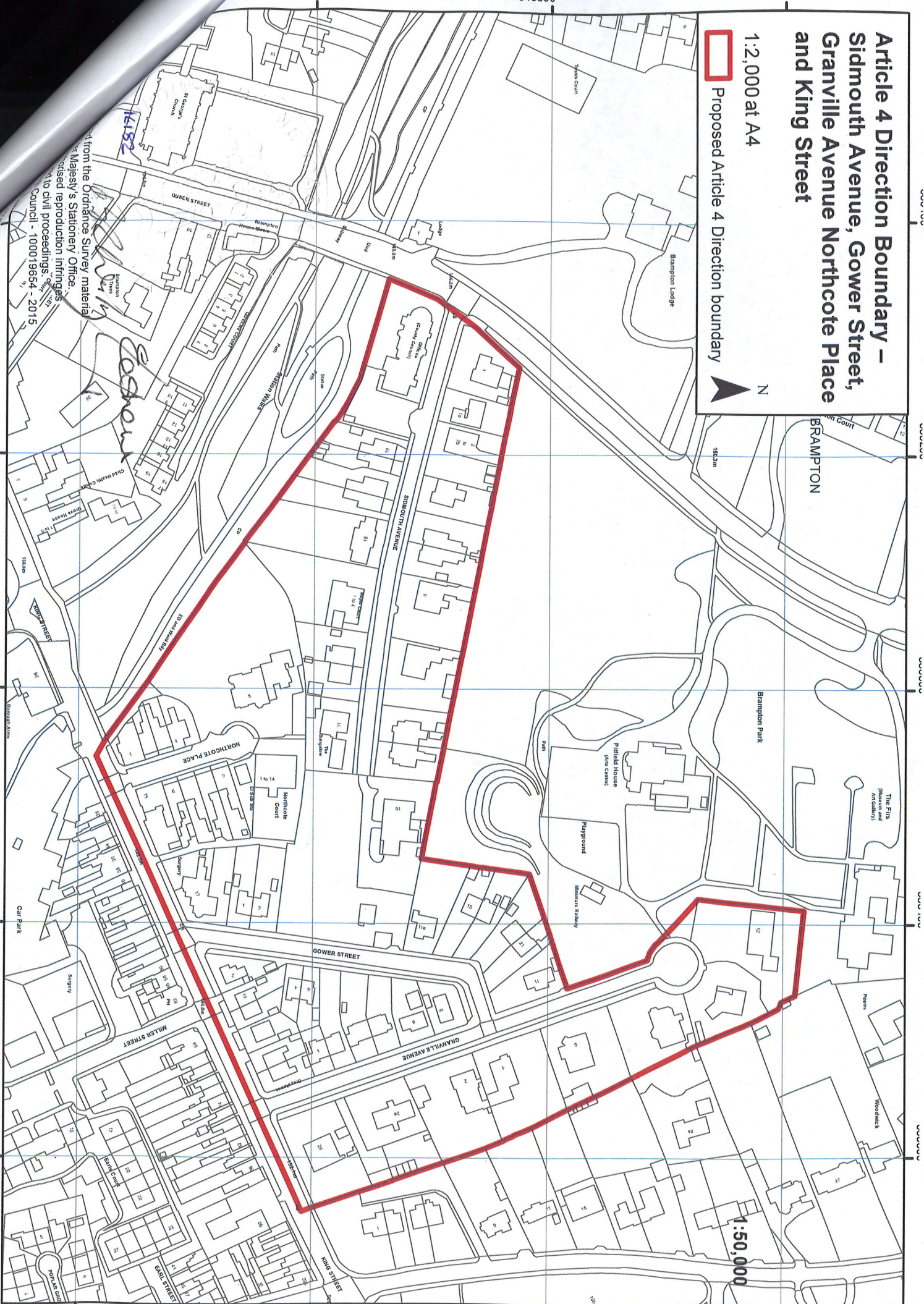

from the Ordnance Survey material
at Majesty's Stationery Office.
Unauthorised reproduction infringes
the Copyright, Designs and Patents
Act 1988 and may lead to civil proceedings.
Council - 100019654 - 2015